

PRESS TOOLING UP TO 108mm

ECO301



Power	Piston Force	Piston Stroke	Item Code
Mains 110V, 560W	Max. 45kN	45mm	39199
Compatible with XPress Systems	Tool Dimensions		Other
Copper, Carbon Steel, Stainless Steel, Copper Gas, Stainless Steel Gas and Solar, Sprinkler ≤ 54mm Carbon Steel and Sprinkler ≤ 54mm Stainless Steel	420 x 85 x 110mm 5.0Kg		Fast pressing cycle for quick installation. Microprocessor driven for constant optimisation of pressing performance
Contains			
S303 ECO301 Carry Case 639 x 466 x 151mm Total Weight: 12.3Kg			

S327 ECO301 PB3 Jaws

Size	a	b	c	Kg	Code
12mm	150	128	39	2	39194
15mm	150	128	39	2	39204
18mm	150	128	39	2	39205
22mm	154	127	39	2	39206
28mm	154	127	39	2	39207
35mm	163	129	39	2	39208

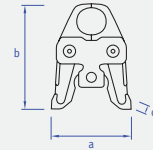

S228 Snap On sling

Size	a	b	c	Kg	Code
42mm	112	100	41	1	39186
54mm	124	112	41	2	39187

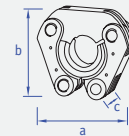

S330 Snap On sling

Size	a	b	c	Kg	Code
66.7mm	151	143	61	4	39220
76.1mm	164	155	61	4	39221
88.9mm	175	167	55	4	39224
108mm	209	205	77	6.3	39225

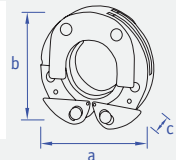

66.7 - 88.9mm

108mm

*S330 in size 108mm is not suitable for copper, use S322

S322 Sling (copper only)

Size	a	b	c	Kg	Code
108mm	200	200	60	5	39222

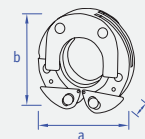

S410 HP Snap On sling

Not suitable for copper

Size	a	b	c	Kg	Code
35mm	112	100	41	2	39268
42mm	125	120	41	2	39269
54mm	125	122	41	2	39271

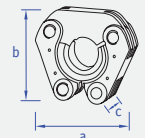

ECO301 continued

S331 ZB323 Adaptor

Size	a	b	c	Kg	Code
66.7-108mm	136	195	43	4	39213

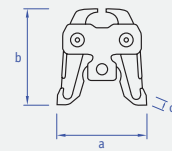

S332 ZB324 Adaptor (2nd Press)

Size	a	b	c	Kg	Code
108mm	136	188	53	4	39214

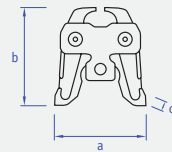

S329 ZB303 Adaptor

Size	a	b	c	Kg	Code
35-54mm	144	129	39	1	39227

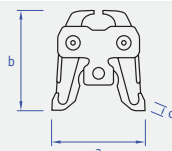

S352 76.1-88.9mm Kit (S330 76.1-88.9mm Slings and ZB324 Adaptor)

Size	Height	Width	Depth	Kg	Code
76.1-88.9mm	355mm	470mm	110mm	14	39042



S352 108mm Kit (S330 108mm Sling and ZB324 Adaptor)

Size	Height	Width	Depth	Kg	Code
108mm	355mm	470mm	110mm	13	39043

